

# Soils Map

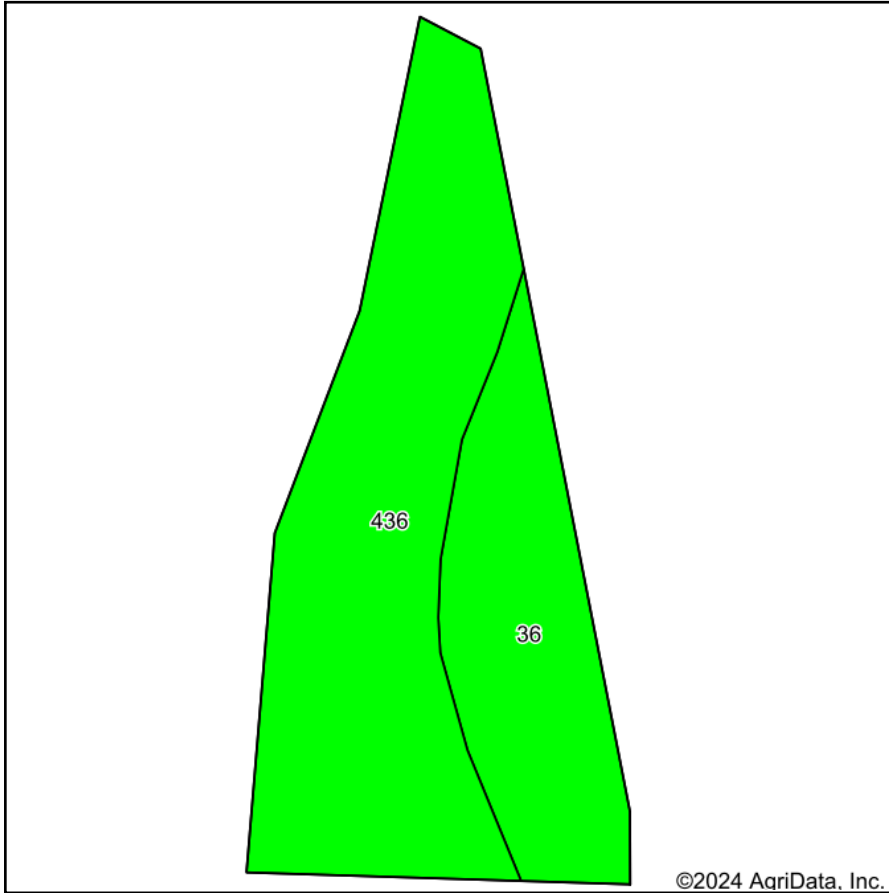

Soils data provided by USDA and NRCS.

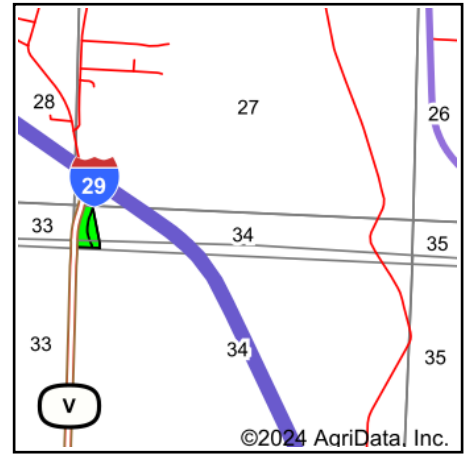

State: **Iowa**  
 County: **Fremont**  
 Location: **34-67N-42W**  
 Township: **Washington**  
 Acres: **5.01**  
 Date: **6/25/2024**



Maps Provided By:



© AgriData, Inc. 2023

www.AgriDataInc.com



Area Symbol: IA071, Soil Area Version: 30

Code	Soil Description	Acres	Percent of field	CSR2 Legend	Non-Irr Class *c	CSR2**	CSR	
436	Lakeport silty clay loam	3.33	66.5%		lw	86	80	
36	Salix silty clay loam	1.68	33.5%		lw	98	90	
<b>Weighted Average</b>						<b>1.00</b>	<b>90</b>	<b>83.4</b>

\*\*IA has updated the CSR values for each county to CSR2.

\*c: Using Capabilities Class Dominant Condition Aggregation Method